



Brand: **KRONER**

### **Mobilier de baie**

***Model:***

Mobilier baie Miriam, nuc, L.99.4xA.47.6xH.45cm, Coloana MIRIAM, nuc, L.40xA.30xH.150cm, Lavoar compozit pentru mobilier Miriam, alb, L.100xA.48xH.17cm, Dulapior baie cu oglinda Miriam, L.100xA.12.7xH.66cm

***Cod Romstal:*** 80TN0012, 80TN0013, 80TN0014, 80TN0015



### ***INSTRUCTIUNI DE INSTALARE***

Revizia nr. 0 / iulie 2011



Bormasina cu percutie



Burghiu  
(D 8)



Ruleta (3m-5m)



Silicon



Creion



Surubelnita

## **INSTRUMENTE NECESARE PENTRU INSTALARE**

## Instructiuni de montare baza si coloana :

### CARCASA MOBILIER

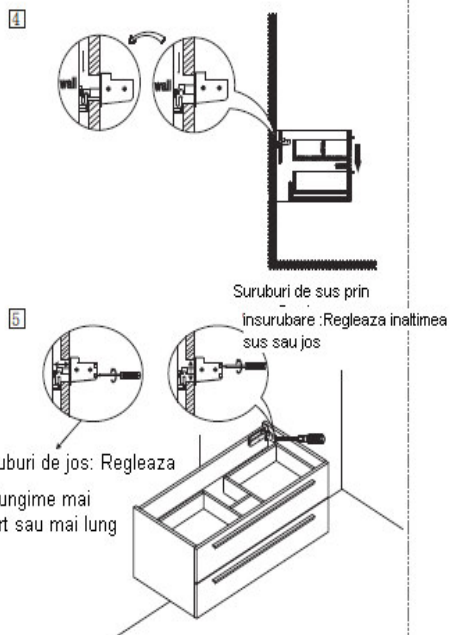
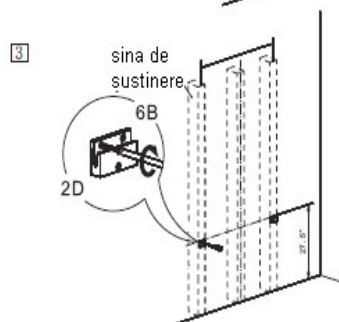
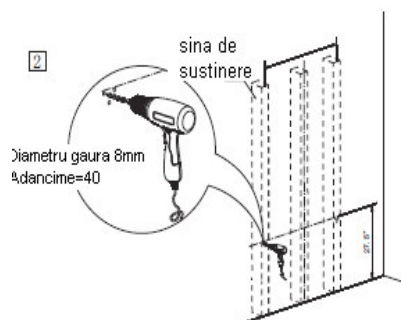
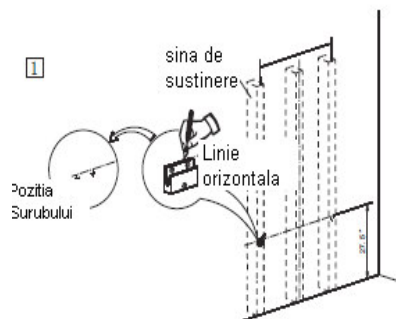
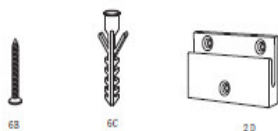

### DULAP DE STOCARE

(Select)

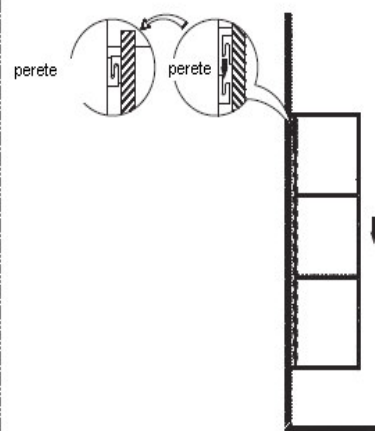
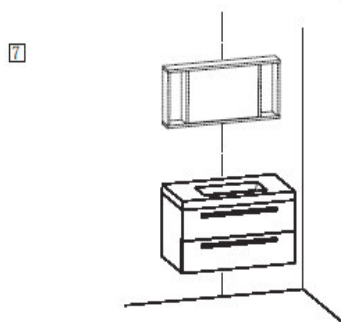
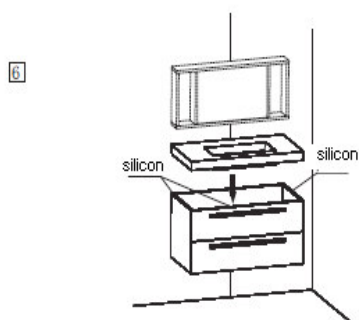

Observatie: Pentru orice reglaj logic necesar, nu se vor mai enunta alte notificari suplimentare.

# Instructiuni montare dulapior oglinda

## Ghid de instalare



Bormasina cu percutie



Burghiu  
(D 8)



Ruleta (3m-5m)



Silicon



Creion



Surubelnita

## INSTRUMENTE NECESARE PENTRU INSTALARE

## OGLINDA



4 buc



4 buc



29 buc



4 buc



29 buc



2 buc  
OGLINDA



2 BUC  
GEAM

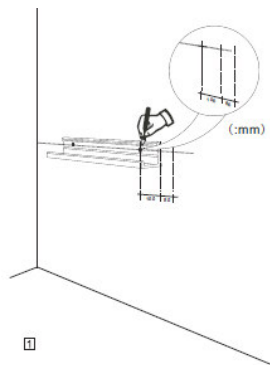

1



1PCS



1PCS

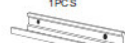

1PCS

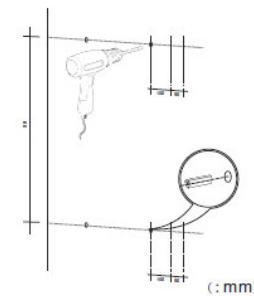

2



3

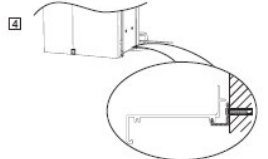

4

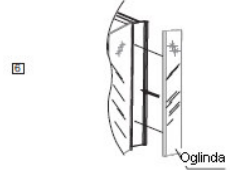

5

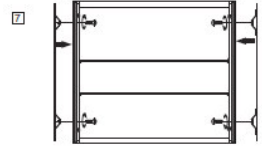

7

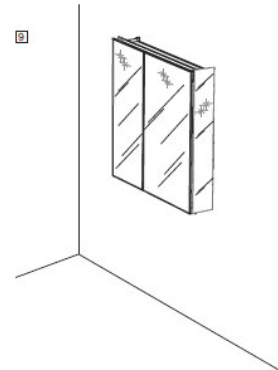

9

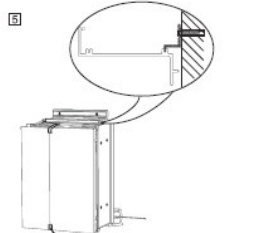

5

Adezivul se utilizeaza pentru a evita craparea usii oglinda in timpul instalarii

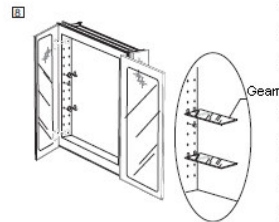

8

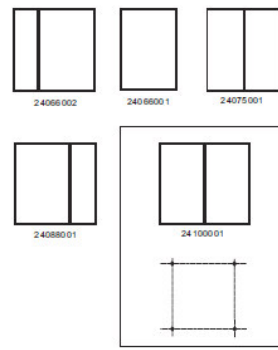

## 1. Instructiuni montare lavoare CE:

Recomandăm [fixarea lavoarelor pe masca](#) dedicata.

Intre perete si lavoar si intre lavoar si masca aferenta puneti un strat subtire de silicon univereal transparent (sau doar puncte de silicon universal transparent) pentru o fixare mai eficienta. Din cauza greutatii lavoarelor si blaturilor, fixarea mecanica nu este necesara.

## 2. Instructiuni intretinere lavoare marmura compozita

Lavoarele din marmura compozita pot fi întreținute cu orice substanță de curățire normală, lichidă, dar nu utilizați niciodată substanțe care contin granule abrazive sau bureți abrazivi. Nu frecați cu acetonă sau soluții acide.

Colorantii din vopselele de par pot afecta stralucirea produselor.

## 3. Instructiuni intretinere mobilier de baie

Curatarea mobilierului de baie se face cu un detergent lichis special pentru aceste suprafete. Nu folositi prafuri de curatat abrazive sau detergenti puternici, solventi, diluanti, acetona, etc. Dupa fiecare folosire se vor indeparta o carpa moale si uscata urmele de apa in exces sau alte substante ramase pe partile mobilierului. Este interzisa udarea cu jet sau cantitati mari de apa a mobilierului.

Colectivul de redactare a cartii tehnice:

Traducere:  
Tehnoredactare:

**Iuliana BELEGANTE**  
**Iuliana BELEGANTE**