

## KRONER Altea

44KR0016

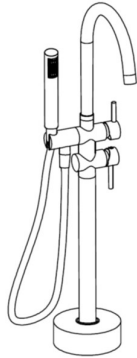

44KR0017

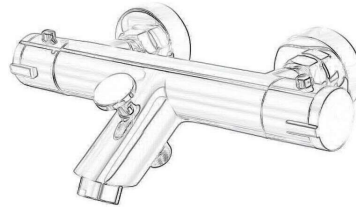

44KR0018

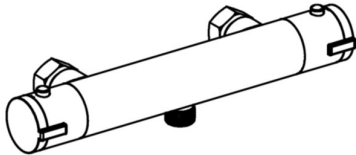

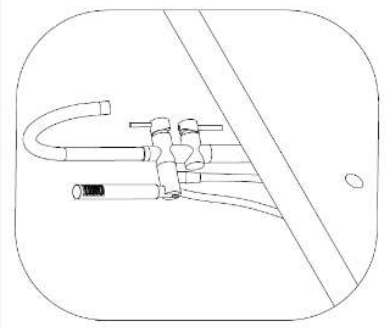

No.	Piesa	buc.
1	baterie	1
2	corp baterie	1
3	ornament	1
4	racord flexibil	2
5	corp fixare	1
6	suruburi	3
7	para dus	1
8	furtun dus	1
9	manusi	1
10	manual instalare	1

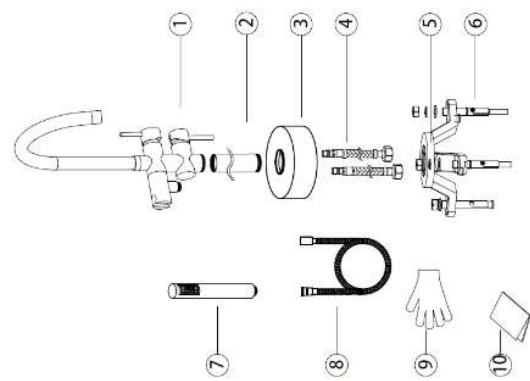

1. Introduceti ornamentul pe corpul bateriei. Treceti racordul flexibil prin corpul de fixare, corpul bateriei. Instalati racordurile flexibile in baterie.

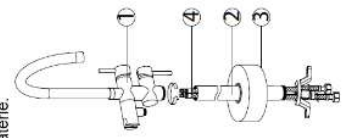

2. Montati corpul bateriei la baterie.

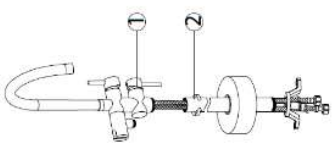

3. Racordurile pentru alimentarea cu apa se instaleaza respectand cotele de mai jos.

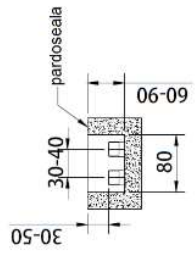

4. Conectati racordurile flexibile la racordurile de alimentare cu apa.

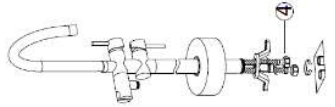

5. Conectati corpul bateriei la corpul de fixare.

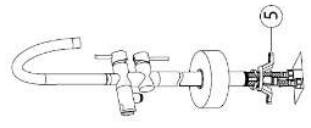

6. Pregatire montaj corp fixare.

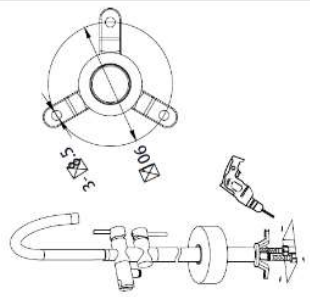

7. Montati corpul de fixare pe pardoseala folosind suruburile (6).

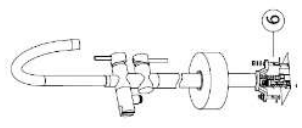

8. Montati furtunul si para de dus.

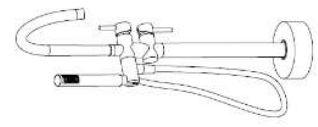
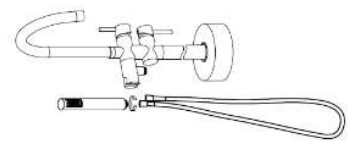

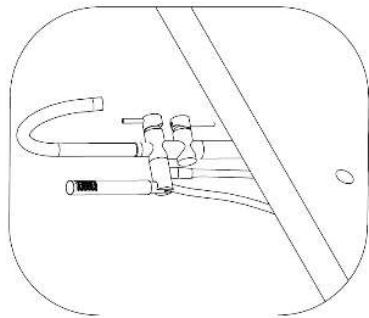

No.	Name	Quantity
1	body assembly	1
2	straight tube	1
3	escutcheon	1
4	flexible hose	2
5	triangle fixing part	1
6	expansion screw	3
7	hand shower	1
8	shower hose	1
9	gloves	1
10	instructions	1

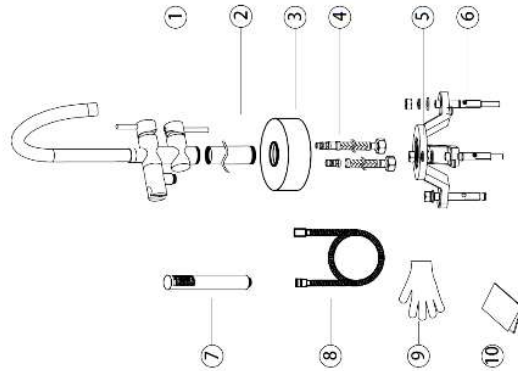

1. Firstly, bunch the straight tube, escutcheon and triangle fixing part into the flexible hose. Then, connect the flexible hose to the body.

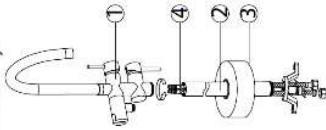

2. Connect the square stem with the main valve.

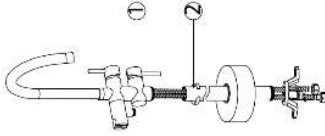

3. Install the inlet pipe per the following drawings.

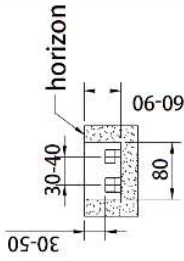

4. Connect the flexible hose to the inlet pipe.

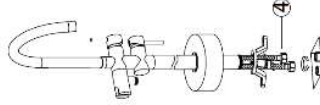

5. Connect the triangle fixing part to the body.

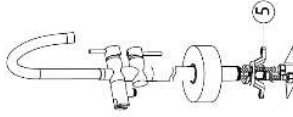

6. Drilling the hole per the drawing dimension.

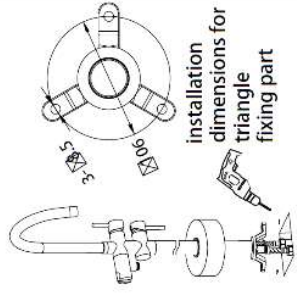

7. Install the faucet body by expansion screw.

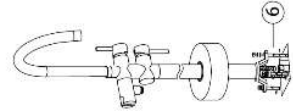

8. Install the hand shower and shower hose.

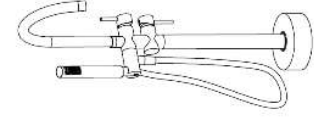
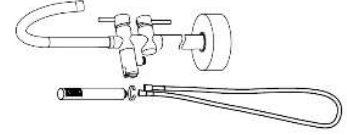

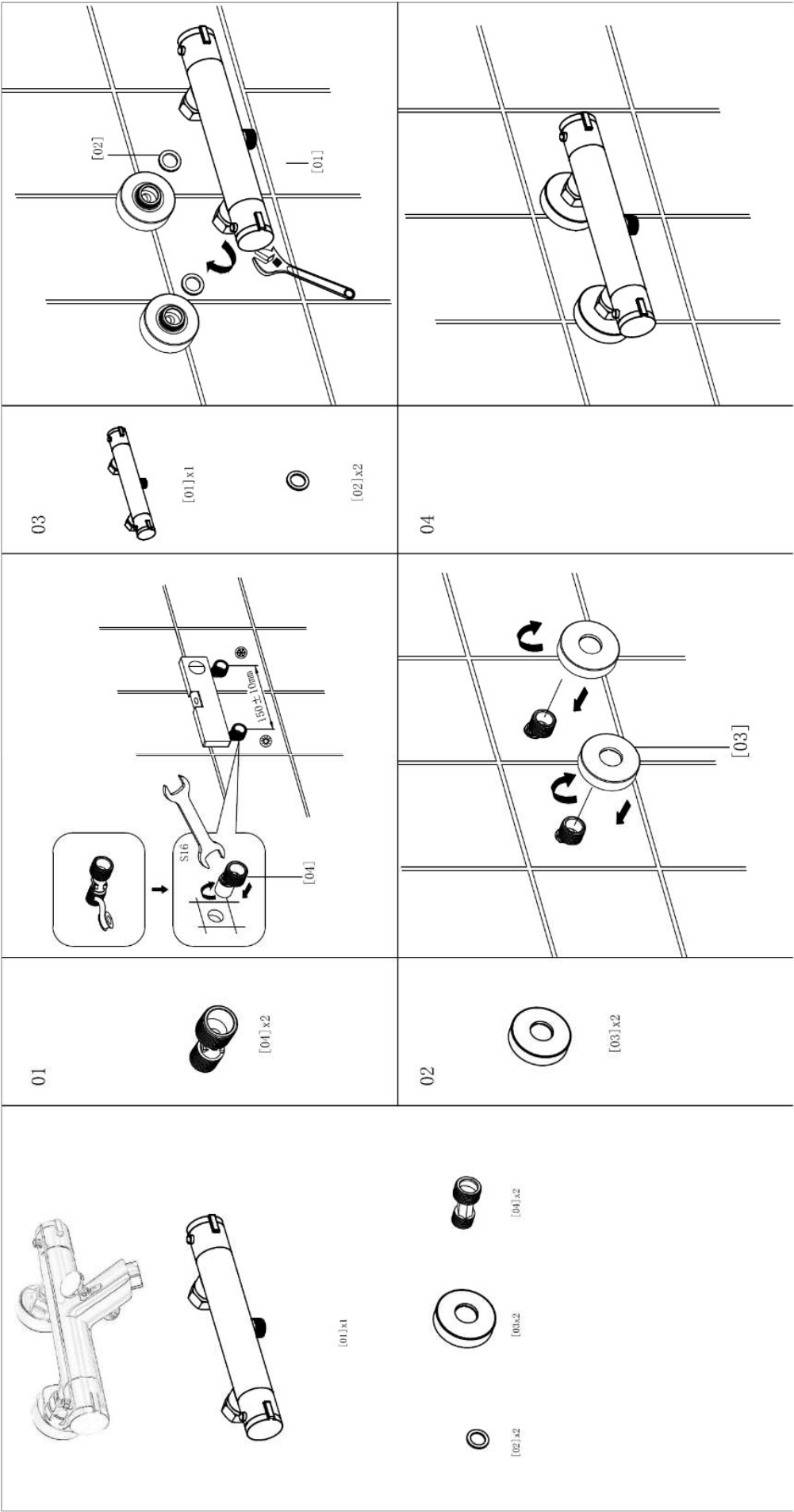

**GB**

Do not use abrasive sponges, scouring agents, organic solvents or acidic cleaners, limescale removers, household vinegar or cleaners containing acetic acid for cleaning.

**BG**

За почистване не използвайте абразивни гъби, абразивни средства, почистващи препарати, съдържащи разтворители или киселини, препарати за отстраняване на котлен камък, домакински оцет или почистващи препарати с оцетна киселина.

**RO**

Nu utilizați pentru curățare bureți duri, substanțe abrazive, substanțe de curățare care conțin solvenți sau acizi, produse anti-tartru, oțet de bucătărie și substanțe de curățare pe bază de acid acetic.

**UA**

Під час очищення не застосовуйте абразивні засоби для чищення, губки, що залишають подряпини, засоби для чищення зі вмістом кислот або розчинників, засоби для видалення вапна, харчовий оцет і засоби для чищення зі вмістом оцтової кислоти.