

## BALL VALVES

0593EN March 2020

VALVE FOR WATER FOR HEATING/COOLING SYSTEMS  
AND NOT DANGEROUS GAS  
STANDARD PORT - R254DL SERIES



**GIACOMINI**  
WATER E-MOTION



R254DL

### Description

Ball valve, with female-male threaded connections.  
Standard port.

### Versions and product codes

Product code	Connections	Finishing	Handle type	Handle color
R254LX001	G 1/4" F x R 1/4"	Chrome plated brass	Lever	Red
R254LX002	G 3/8" F x R 3/8"	Chrome plated brass	Lever	Red
R254LX003	G 1/2" F x R 1/2"	Chrome plated brass	Lever	Red
R254LX004	G 3/4" F x R 3/4"	Chrome plated brass	Lever	Red
R254LX005	G 1" F x R 1"	Chrome plated brass	Lever	Red
R254LX006	G 1-1/4" F x R 1-1/4"	Chrome plated brass	Lever	Red
R254LX007	G 1-1/2" F x G 1-1/2" M	Chrome plated brass	Lever	Red
R254LX008	G 2" F x G 2" M	Chrome plated brass	Lever	Red

### Technical data

#### Main features and materials

- Suitable for water for heating/cooling systems and not dangerous gas
- Standard port
- Valve made of UNI EN 12165 CW617N chrome plated brass
- Stem with double O-Ring
- Nut with anti-corrosion coating, with guarantee seal and hologram
- Steel lever handle with anti-corrosion treatment and red PVC coating

#### Field of applications

- Min. working temperature: -20 °C with 50 % glycol solutions
- Max. working temperature with dry saturated steam: 185 °C with 1,05 MPa (10,5 bar)
- Max. working pressure at 20 °C with water and not dangerous gas: 4,2 MPa (42 bar) for 1/4", 3/8", 1/2", 3/4" 3,5 MPa (35 bar) for 1", 1-1/4", 1-1/2", 2"

### Dimensions and Kv

Product code	DN	A [mm]	I [mm]	B [mm]	J [mm]	C [mm]	H [mm]	Kv
R254LX001	8	51	21	36	10	43	wr.17	6,6
R254LX002	10	55	22	46	14	77	wr.21	6,7
R254LX003	14	64	27	49	15	77	wr.25	10,2
R254LX004	18	76	31	64	18	94	wr.32	18,5
R254LX005	22	89	38	73	23	94	wr.39	36,3
R254LX006	28	100	42	82	28	94	wr.48	73,5
R254LX007	35	105	46	100	33	136	wr.55	105
R254LX008	45	124	54	115	41	136	wr.67	158

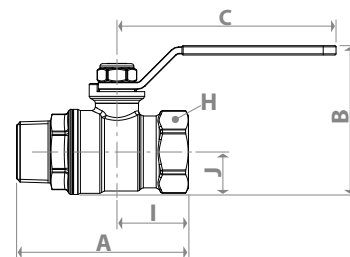

### Product specifications

#### R254DL - Red lever

Ball valve, with female-male threaded connections. Suitable for water for heating/cooling systems and not dangerous gas. Valve made of UNI EN 12165 CW617N chrome plated brass. Standard port. Steel lever handle with anti-corrosion treatment and red PVC coating. Stem with double O-Ring. Nut with anti-corrosion coating, with guarantee seal and hologram. Min. working temperature: -20 °C with 50 % glycol solutions. Max. working temperature with dry saturated steam: 185 °C with 1,05 MPa (10,5 bar). Max. working pressure at 20 °C with water and not dangerous gas: 4,2 MPa (42 bar) for 1/4", 3/8", 1/2", 3/4"; 3,5 MPa (35 bar) for 1", 1-1/4", 1-1/2", 2".

## BALL VALVES

0593EN March 2020

VALVE FOR DANGEROUS GAS AND LIQUID HYDROCARBONS  
STANDARD PORT - R254DL SERIES



**GIACOMINI**  
WATER E-MOTION



R254DL

### Description

Ball valve, with female-male threaded connections.  
Standard port.

### Versions and product codes

Product code	Connections	Finishing	Handle type	Handle color
R254LX021	G 1/4" F x R 1/4"	Chrome plated brass	Lever	Yellow
R254LX022	G 3/8" F x R 3/8"	Chrome plated brass	Lever	Yellow
R254LX023	G 1/2" F x R 1/2"	Chrome plated brass	Lever	Yellow
R254LX024	G 3/4" F x R 3/4"	Chrome plated brass	Lever	Yellow
R254LX025	G 1" F x R 1"	Chrome plated brass	Lever	Yellow
R254LX026	G 1-1/4" F x R 1-1/4"	Chrome plated brass	Lever	Yellow
R254LX027	G 1-1/2" F x G 1-1/2" M	Chrome plated brass	Lever	Yellow
R254LX028	G 2" F x G 2" M	Chrome plated brass	Lever	Yellow

### Technical data

#### Main features and materials

- Suitable for dangerous gas and liquid hydrocarbons\*
- Standard port
- Valve made of UNI EN 12165 CW617N chrome plated brass
- Stem with double O-Ring
- Nut with anti-corrosion coating, with guarantee seal and hologram
- Steel lever handle with anti-corrosion treatment and yellow PVC coating

#### Field of applications

- Temperature range: -20÷60 °C
- Max. working pressure at 20 °C with liquid hydrocarbons\*: 1,2 MPa (12 bar)
- Max. operating pressure (MOP) with gas: 0,5 MPa (5 bar)

\* Please consult Giacomini technical support, to check the compatibility of the product with the specific hydrocarbon.

### Dimensions

Product code	DN	A [mm]	I [mm]	B [mm]	J [mm]	C [mm]	H [mm]
R254LX021	8	51	21	36	10	43	wr.17
R254LX022	10	55	22	46	14	77	wr.21
R254LX023	14	64	27	49	15	77	wr.25
R254LX024	18	76	31	64	18	94	wr.32
R254LX025	22	89	38	73	23	94	wr.39
R254LX026	28	100	42	82	28	94	wr.48
R254LX027	35	105	46	100	33	136	wr.55
R254LX028	45	124	54	115	41	136	wr.67

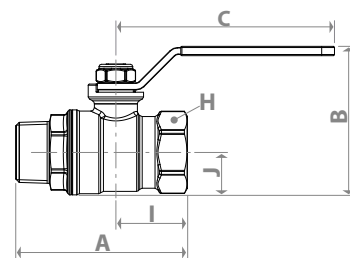

### Product specifications

#### R254DL - Yellow lever

Ball valve, with female-male threaded connections. Suitable for dangerous gas and liquid hydrocarbons. Valve made of UNI EN 12165 CW617N chrome plated brass. Standard port. Steel lever handle with anti-corrosion treatment and yellow PVC coating. Stem with double O-Ring. Nut with anti-corrosion coating, with guarantee seal and hologram. Temperature range: -20÷60 °C. Max. working pressure at 20 °C with liquid hydrocarbons: 1,2 MPa (12 bar). Max. operating pressure (MOP) with gas: 0,5 MPa (5 bar).

#### Additional information

For more information, go to [www.giacomini.com](http://www.giacomini.com) or contact our technical assistance service: ☎ +39 0322 923372 📠 +39 0322 923255 ✉ [consulenza.prodotti@giacomini.com](mailto:consulenza.prodotti@giacomini.com)

This document provides only general indications. Giacomini S.p.A. may change at any time, without notice and for technical or commercial reasons, the items included herewith.

The information included in this technical sheet do not exempt the user from strictly complying with the rules and good practice standard in force.

Giacomini S.p.A. Via per Alzo, 39 - 28017 San Maurizio d'Opaglio (NO) Italy