

BALL VALVES

0603EN March 2020

VALVE FOR WATER FOR HEATING/COOLING SYSTEMS
AND NOT DANGEROUS GAS
STANDARD PORT - R253D SERIES



GIACOMINI
WATER E-MOTION



R253D

Description

Ball valve, with male-male threaded connections.
Standard port.

Versions and product codes

Product code	Connections	Finishing	Handle type	Handle color
R253X002	R 3/8" x R 3/8"	Chrome plated brass	T-handle	Red
R253X003	R 1/2" x R 1/2"	Chrome plated brass	T-handle	Red
R253X004	R 3/4" x R 3/4"	Chrome plated brass	T-handle	Red
R253X005	R 1" x R 1"	Chrome plated brass	T-handle	Red
R253X006	R 1-1/4" x R 1-1/4"	Chrome plated brass	T-handle	Red

Technical data

Main features and materials

- Suitable for water for heating/cooling systems and not dangerous gas
- Standard port
- Valve made of UNI EN 12165 CW617N chrome plated brass
- Stem with double O-Ring
- Nut with anti-corrosion coating, with guarantee seal and hologram
- Aluminium T-handle, red painted

Field of applications

- Min. working temperature: -20 °C with 50 % glycol solutions
- Max. working temperature with dry saturated steam: 185 °C with 1,05 MPa (10,5 bar)
- Max. working pressure at 20 °C with water and not dangerous gas: 4,2 MPa (42 bar) for 3/8", 1/2", 3/4"
3,5 MPa (35 bar) for 1", 1-1/4"

Dimensions and Kv

Product code	DN	A [mm]	I [mm]	B [mm]	J [mm]	C [mm]	H [mm]	Kv
R253X002	10	58	26	49	14	63	wr.19	6,7
R253X003	14	66	29	51	15	63	wr.22	10,2
R253X004	18	79	33	60	19	73	wr.29	18,5
R253X005	22	91	40	69	23	73	wr.36	36,3
R253X006	28	108	47	78	28	73	wr.44	73,5

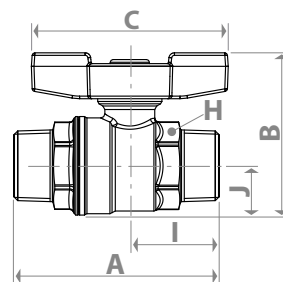

Product specifications

R253D - Red T-handle

Ball valve, with male-male threaded connections. Suitable for water for heating/cooling systems and not dangerous gas. Valve made of UNI EN 12165 CW617N chrome plated brass. Standard port. Aluminium T-handle, red painted. Stem with double O-Ring. Nut with anti-corrosion coating, with guarantee seal and hologram. Min. working temperature: -20 °C with 50 % glycol solutions. Max. working temperature with dry saturated steam: 185 °C with 1,05 MPa (10,5 bar). Max. working pressure at 20 °C with water and not dangerous gas: 4,2 MPa (42 bar) for 3/8", 1/2", 3/4"; 3,5 MPa (35 bar) for 1", 1-1/4".

BALL VALVES

0603EN March 2020

VALVE FOR DANGEROUS GAS AND LIQUID HYDROCARBONS
STANDARD PORT - R253D SERIES



GIACOMINI
WATER E-MOTION



R253D

Description

Ball valve, with male-male threaded connections.
Standard port.

Versions and product codes

Product code	Connections	Finishing	Handle type	Handle color
R253X022	R 3/8" x R 3/8"	Chrome plated brass	T-handle	Yellow
R253X023	R 1/2" x R 1/2"	Chrome plated brass	T-handle	Yellow
R253X024	R 3/4" x R 3/4"	Chrome plated brass	T-handle	Yellow
R253X025	R 1" x R 1"	Chrome plated brass	T-handle	Yellow
R253X026	R 1-1/4" x R 1-1/4"	Chrome plated brass	T-handle	Yellow

Technical data

Main features and materials

- Suitable for dangerous gas and liquid hydrocarbons*
- Standard port
- Valve made of UNI EN 12165 CW617N chrome plated brass
- Stem with double O-Ring
- Nut with anti-corrosion coating, with guarantee seal and hologram
- Aluminium T-handle, yellow painted

Field of applications

- Temperature range: -20÷60 °C
- Max. working pressure at 20 °C with liquid hydrocarbons*: 1,2 MPa (12 bar)
- Max. operating pressure (MOP) with gas: 0,5 MPa (5 bar)

* Please consult Giacomini technical support, to check the compatibility of the product with the specific hydrocarbon.

Dimensions

Product code	DN	A [mm]	I [mm]	B [mm]	J [mm]	C [mm]	H [mm]
R253X022	10	58	26	49	14	63	19
R253X023	14	66	29	51	15	63	22
R253X024	18	79	33	60	19	73	29
R253X025	22	91	40	69	23	73	36
R253X026	28	108	47	78	28	73	44

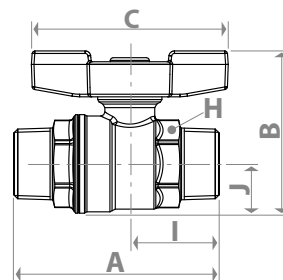

Product specifications

R253D - Yellow T-handle

Ball valve, with male-male threaded connections. Suitable for dangerous gas and liquid hydrocarbons. Valve made of UNI EN 12165 CW617N chrome plated brass. Standard port. Aluminium T-handle, yellow painted. Stem with double O-Ring. Nut with anti-corrosion coating, with guarantee seal and hologram. Temperature range: -20÷60 °C. Max. working pressure at 20 °C with liquid hydrocarbons: 1,2 MPa (12 bar). Max. operating pressure (MOP) with gas: 0,5 MPa (5 bar).

Additional information

For more information, go to www.giacomini.com or contact our technical assistance service: ☎ +39 0322 923372 📠 +39 0322 923255 ✉ consulenza.prodotti@giacomini.com

This document provides only general indications. Giacomini S.p.A. may change at any time, without notice and for technical or commercial reasons, the items included herewith.

The information included in this technical sheet does not exempt the user from strictly complying with the rules and good practice standards in force.

Giacomini S.p.A. Via per Alzo, 39 - 28017 San Maurizio d'Opaglio (NO) Italy