

Destinatar

Firma
Referinta
Adresa
Phone
Fax
E-mail

Expeditor

Cod articol :

60150943

Articol:

EVOPLUS 60/180 XM

Date pompa

Presiune nominala: 232,05 psi
Temperatura min. fluid -10 °C
Temperatura max. fluid 110 °C
EEI : ≤ 0,22

Presiune minima la nivelul apei:

Temperatura : °C 90 100
Presiune minima la nivelul apei: m 20 25

Date de functionare cerute

Debit :
Inaltime de pompare :
Fluid pompat (%) :
Temperatura fluid: 20 °C
Densitate 998,3 kg/m³
Vasozitate cinematica: 1,005 mm²/s
Presiune de vapori:

Date disponibile:

Debit :
Inaltime de pompare :

Materiale

Corp pompa Cast iron 250 UNI ISO 185 - CTF
Rotor Tecnopolimer
Arbore motor Alumina
Inel de etansare EPDM
Carcasa motorului Aluminu turnat la cald
Flansa de inchidere Otel inox
Suport inel de echilibrare EPDM

Curve tolerance according to ISO 9906

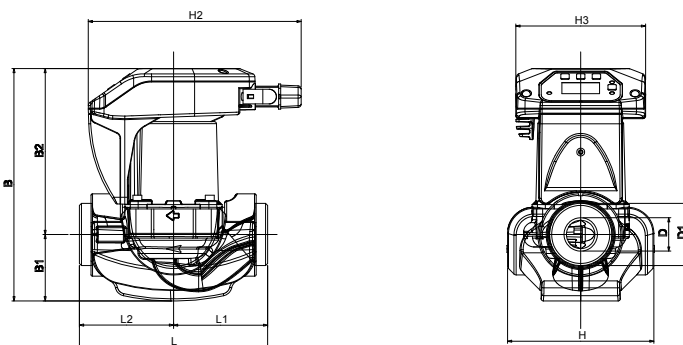
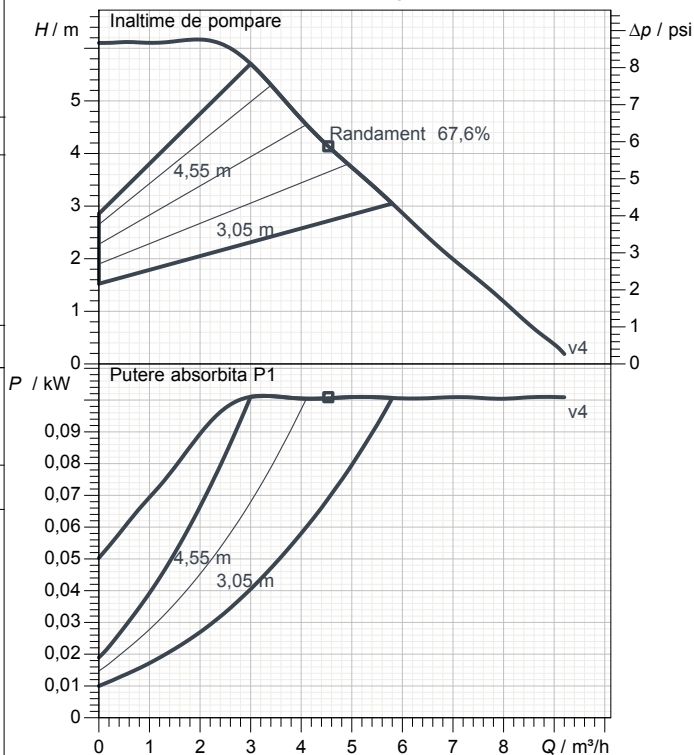

Date motor

Marca : DAB
Putere absorbita P1 0,1 kW
Tensiune nominala : 1~ 220-240 V 50 Hz
Curent nominal : 0,71 A
Grad de protectie: IP 44

Dimensiuni de gabarit mm

B	224	H1	124				
B1	65	H2	204				
B2	159	L	180				
D	32	L1	90				
D1	2" G	L2	90				
H	124						

Masa 4,7 kg

Racorduri pompa:

Partea cu aspiratia: 2" G
Partea cu refularea: 2" G

Destinatar

Expeditor

Firma
Referinta
Adresa
Phone
Fax
E-mail

EVOPLUS 60/180 XM

Curve tolerance according to ISO 9906

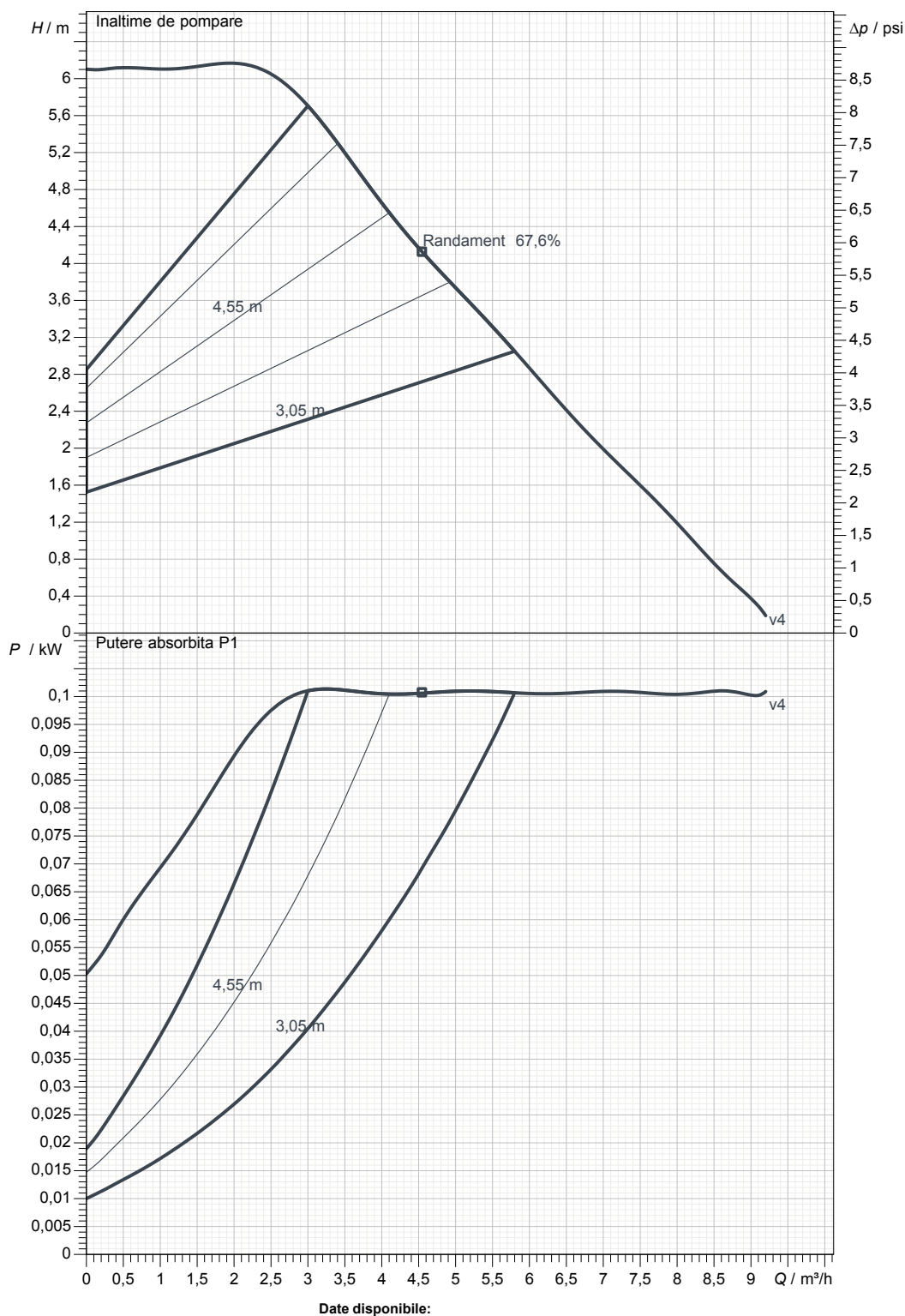

Date disponibile:

Partea cu aspiratia:
2" G
16 bar (1600 kPa)

Partea cu refularea:
2" G
16 bar (1600 kPa)

Debit :

Înaltime de pompare :

Viteza nominala:
2900 1/min

MAIN_PROJECT_TITLE

BUSINESS_PROCESS_IC

OWNER_

ISSUE_DATE



DESEN DIMENSIONAL

10/29/2015

Pagina 3 / 3

DAB PUMPS S.p.A.
Via Marco Polo, 14 - 35035 Mestrino (PD), Italy
Tel. +39 049 5125000 - Fax +39 049 5125950
www.dabpumps.com

Destinatar

Expeditor

Firma
Referinta
Adresa
Phone
Fax
E-mail

EVOPLUS 60/180 XM

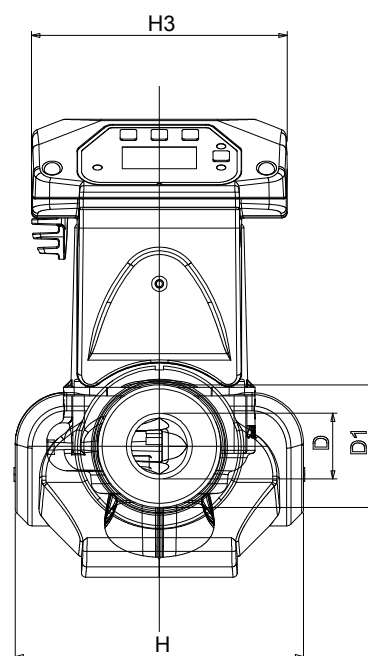
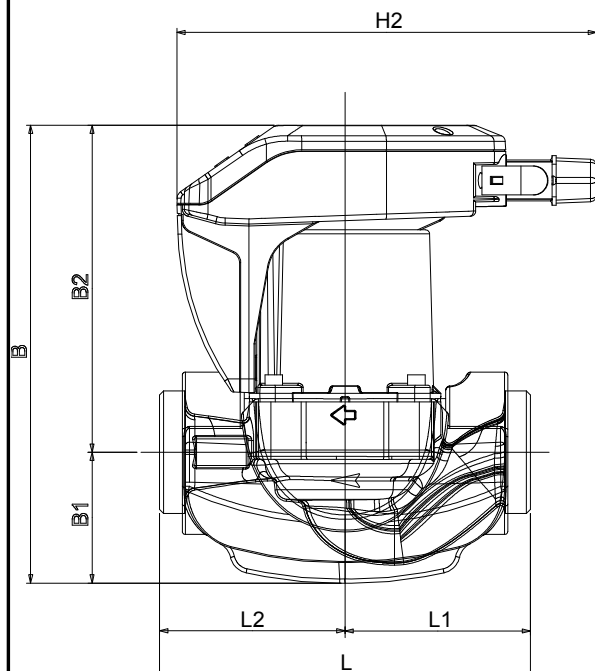

Dimensiuni in mm

Racorduri pompa:

1	B	224					
2	B1	65					Aspiratie
3	B2	159					2" G
4	D	32					16 bar (1600 kPa)
5	D1	2" G					
6	H	124					Refulare
7	H1	124					2" G
8	H2	204					16 bar (1600 kPa)
9	L	180					
10	L1	90					
11	L2	90					

MAIN_PROJECT_TITLE

BUSINESS_PROCESS_IC

OWNER_

ISSUE_DATE