



BIANCHI F.lli S.p.A.
Rubinetteria

Valvola a sfera FF PN25 con spurgo, maniglia a leva in ferro

Art. 433

Valvola a sfera FF PN25 con spurgo, maniglia a leva in ferro

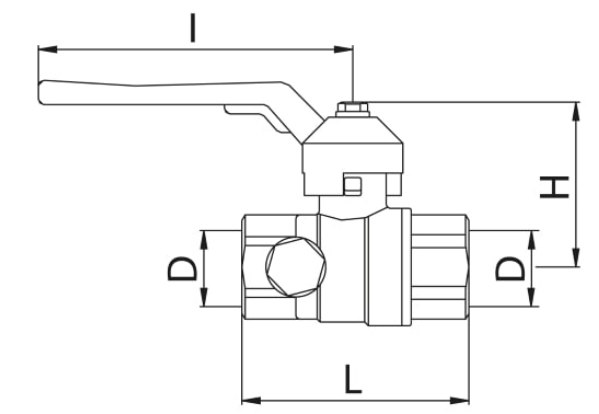

Articoli

Codice	Dimensione (D)	Finitura	Maniglia	Imballo	D1	I	L	h
433000040A	1/2"	●	● Ferro	12	1/4"	84.0	58.0	49.0
433000040F	1/2"	●	● Ferro	12	1/4"	84.0	58.0	49.0
433000060A	1"	●	● Ferro	6	1/4"	107.0	73.0	60.0
433000070A	1 1/4"	●	● Ferro	4	1/4"	138.0	86.0	75.0
433000080A	1 1/2"	●	● Ferro	4	1/4"	138.0	93.0	81.0
433000090A	2"	●	● Ferro	2	1/4"	155.0	112.0	96.0

FINITURA

- Giallo
- Cromo
- Nichel
- Bianco

Temperatura d'esercizio: 0-110°C

Corpo in ottone stampato

