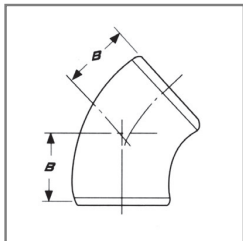
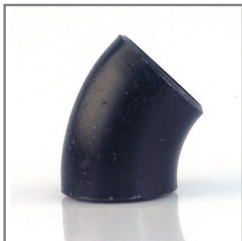
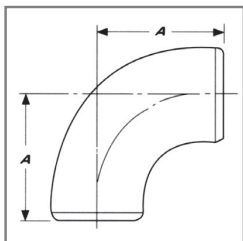
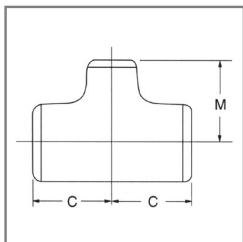

**COT LA 45° - ANSI B.16-9**  
**УГОЛОК ПОД 45° - ANSI B.16-9**

DN (mm) (мм)	Ø (toli) (дюйм)	D. EXT. НАРУЖН НАРУЖН	COTA B Высота	COD ROMSTAL КОД ROMSTAL
15	1/2"	21	16	45974001
20	3/4"	27	11	45974002
25	1"	33	22	45974003
32	1 1/4"	42	25	45974004
40	1 1/2"	48	29	45974005
50	2"	60	35	45974006
65	2 1/2"	73	44	45974007
80	3"	89	51	45974008
100	4"	114	64	45974009
125	5"	141	79	45974010
150	6"	168	95	45974011

**COT LA 90° - ANSI B.16-9**  
**УГОЛОК ПОД 90° - ANSI B.16-9**

DN (mm) (мм)	Ø (toli) (дюйм)	D. EXT. НАРУЖН НАРУЖН	COTA A Высота	COD ROMSTAL КОД ROMSTAL
15	1/2"	21	38	45979001
20	3/4"	27	29	45979002
25	1"	33	38	45979003
32	1 1/4"	42	48	45979004
40	1 1/2"	48	57	45979005
50	2"	60	76	45979006
65	2 1/2"	73	95	45979007
80	3"	89	114	45979008
100	4"	114	152	45979009
125	5"	141	190	45979010
150	6"	168	229	45979011

**TEU EGAL - ANSI B.16-9**  
**ТРОЙНИК РАВНОПРОХОДНЫЙ - ANSI B.16-9**

DN (mm) (мм)	Ø (toli) (дюйм)	D. EXT. НАРУЖН НАРУЖН	COTA C Высота	COTA M Высота	COD ROMSTAL КОД ROMSTAL
15	1/2"	21	25	25	45971301
20	3/4"	27	29	29	45971302
25	1"	33	38	38	45971303
32	1 1/4"	42	48	48	45971304
40	1 1/2"	48	57	57	45971305
50	2"	60	64	64	45971306
65	2 1/2"	73	76	76	45971307
80	3"	89	86	86	45971308
100	4"	114	105	105	45971309
125	5"	141	124	124	45971310
150	6"	168	143	143	45971311

**REDUCȚIE CONCENTRICĂ SUDABILĂ - ANSI B.16-9**  
**ПЕРЕХОДНИК КОНЦЕНТРИЧЕСКИЙ - ANSI B.16-9**

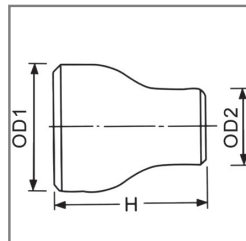

Ø (toli) (дюйм)	D. OD1	D. OD2	COTA H Высота	COD ROMSTAL КОД ROMSTAL
1 1/4 x 1"	42	33	51	45972402
1 1/4 x 3/4"	42	27	51	45972401
1 1/2 x 1 1/4"	48	42	64	45972406
1 1/2 x 1"	48	33	64	45972405
1 1/2 x 3/4"	48	27	64	45972404
1 1/2 x 1/2"	48	21	64	45972403
2 x 1/2"	60	21	76	45972407
2 x 1 1/2"	60	48	76	45972411
2 x 1 1/4"	60	42	76	45972410
2 x 1"	60	33	76	45972409
2 x 3/4"	60	27	76	45972408
2 1/2 x 2"	73	60	89	45972415
2 1/2 x 1 1/2"	73	48	89	45972414
2 1/2 x 1 1/4"	73	42	89	45972413
2 1/2 x 1"	73	33	89	45972412
3 x 1"	89	33	89	45972416
3 x 2 1/2"	89	73	89	45972420
3 x 2"	89	60	89	45972419
3 x 1 1/4"	89	48	89	45972417
3 x 1 1/2"	89	42	89	45972418
4 x 1 1/4"	114	48	102	45972421
4 x 3"	114	89	102	45972425
4 x 2 1/2"	114	73	102	45972424
4 x 2"	114	60	102	45972423
4 x 1 1/2"	114	48	102	45972422
5 x 4"	141	114	127	45972429

**REDUCȚIE CONCENTRICĂ SUDABILĂ - ANSI B.16-9**  
**ПЕРЕХОДНИК КОНЦЕНТРИЧЕСКИЙ - ANSI B.16-9**

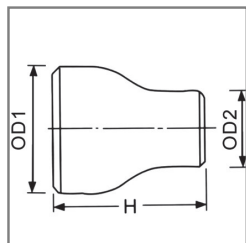

Ø (toli) (дюйм)	D. OD1	D. OD2	COTA H Высота	COD ROMSTAL КОД ROMSTAL
5 x 3"	141	89	127	45972428
6 x 5"	168	141	140	45972432
6 x 4"	168	114	140	45972431
6 x 3"	168	89	140	45972430

**REDUCȚIE EXCENTRICĂ SUDABILĂ - ANSI B.16-9**  
**ПЕРЕХОДНИК ЭКСЦЕНТРИЧЕСКИЙ - ANSI B.16-9**

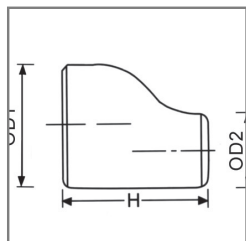

Ø (toli) (дюйм)	D. OD1	D. OD2	COTA H Высота	COD ROMSTAL КОД ROMSTAL
1 1/4 x 3/4"	42	27	51	45982401
1 1/2 x 1 1/4"	48	42	64	45982406
1 1/2 x 1"	48	33	64	45982405
1 1/2 x 3/4"	48	27	64	45982404
1 1/2 x 1/2"	48	21	64	45982403
2 x 1 1/4"	60	42	76	45982410
2 x 1"	60	33	76	45982409
2 1/2 x 2"	73	60	89	45982415
2 1/2 x 1 1/2"	73	48	89	45982414
2 1/2 x 1 1/4"	73	42	89	45982413
2 1/2 x 1"	73	33	89	45982412
3 x 2 1/2"	89	73	89	45982420
3 x 2"	89	60	89	45982419
3 x 1 1/4"	89	42	89	45982417
3 x 1 1/2"	89	48	89	45982418

**REDUCȚIE EXCENTRICĂ SUDABILĂ - ANSI B.16-9**  
**ПЕРЕХОДНИК ЭКСЦЕНТРИЧЕСКИЙ- ANSI B.16-9**

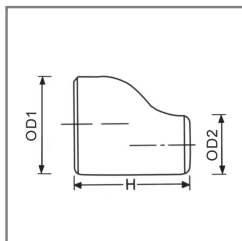

Ø (toli) (дюйм)	D. OD1	D. OD2	COTA H Высота	COD ROMSTAL КОД ROMSTAL
3 x 1 1/2"	89	42	89	45982418
4 x 3"	114	89	102	45982425
4 x 2 1/2"	114	73	102	45982424
5 x 4"	141	114	127	45982429
5 x 3"	141	89	127	45982428
6 x 5"	168	141	140	45982432
6 x 4"	168	114	140	45982431
6 x 3"	168	89	140	45982430

**RACORDURI SUDABILE DIN OTEL GAMA UȘOARĂ**  
**СТАЛЬНЫЕ ФИТИНГИ ПОД СВАРКУ, ТОНКОСТЕННЫЕ**

**COT LA 45° - DIN 2605-1**  
**УГОЛОК ПОД 45° - DIN 2605-1**

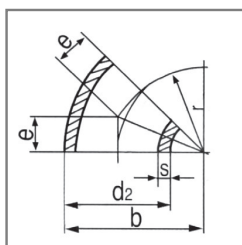

DN (mm) (мм)	Ø (toli) (дюйм)	RAZA d <sub>2</sub> угол	RAZA r угол	RAZA b угол	COD ROMSTAL КОД ROMSTAL
15	1/2"	21.3	28	38	45999042
20	3/4"	26.9	29	43	45999043
25	1"	33.7	38	56	45999044
32	1 1/4"	42.4	48	69	45999045
40	1 1/2"	48.3	57	82	45999046
50	2"	60.3	76	106	45999047
65	2 1/2"	76.1	95	133	45999048
80	3"	88.9	114	159	45999049
100	4"	114.3	152	210	45999050
125	5"	139.7	190	260	45999051
150	6"	168.3	229	313	45999052

**COT LA 90° - DIN 2605-1**  
**УГОЛОК ПОД 90° - DIN 2605-1**

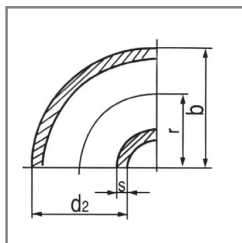

DN (mm) (мм)	Ø (toli) (дюйм)	RAZA d <sub>2</sub> угол	RAZA r угол	RAZA b угол	COD ROMSTAL КОД ROMSTAL
15	1/2"	21.3	28	38	45999001
20	3/4"	26.9	29	43	45999002
25	1"	33.7	38	56	45999003
32	1 1/4"	42.4	48	69	45999004
40	1 1/2"	48.3	57	82	45999005
50	2"	60.3	76	106	45999006
65	2 1/2"	76.1	95	133	45999007
80	3"	88.9	114	159	45999008
100	4"	114.3	152	210	45999009
125	5"	139.7	190	260	45999010
150	6"	168.3	229	313	45999011
200	8"	219.1	305	414	45999066
250	10"	273	381	518	45999067

**TEU SUDABIL EGAL - DIN 2605-1**

ТРОЙНИК РАВНОПРОХОДНЫЙ - DIN 2605-1

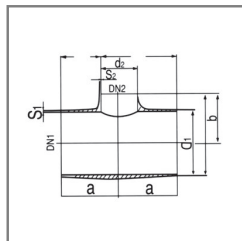

DN(mm) (мм)	Ø(toli) (дюйм)	COTA d <sub>2</sub> Высота	COTA A Высота	G <sub>perete</sub> s <sub>1</sub> стенка	COD ROMSTAL КОД ROMSTAL
15	1/2"	21.3	25	2.0	45999053
20	3/4"	26.9	29	2.3	45999054
25	1"	33.7	38	2.6	45999055
32	1 1/4"	42.4	48	2.6	45999056
40	1 1/2"	48.3	57	2.6	45999057
50	2"	60.3	64	2.9	45999058
65	2 1/2"	76.1	76	2.9	45999059
80	3"	88.9	86	3.2	45999060
100	4"	114.3	105	3.6	45999061
125	5"	139.7	124	4	45999062
150	6"	168.3	143	4.5	45999063
200	8"	219.1	178	6.3	45999064
250	10"	273	216	6.3	45999065

**CAPAC SUDABIL - DIN 2605-1**

ЗАГЛУШКА - DIN 2605-1

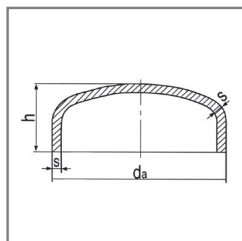

DN(mm) (мм)	Ø(toli) (дюйм)	COTA d <sub>a</sub> Высота	G <sub>perete</sub> s стенка	COTA h Высота	COD ROMSTAL КОД ROMSTAL
20	3/4"	26.9	2.3	25	72760001
25	1"	33.7	2.6	38	72760002
32	1 1/4"	42.4	2.6	38	72760003
40	1 1/2"	48.3	2.6	38	72760004
50	2"	60.3	2.9	38	72760006
65	2 1/2"	76.1	2.9	38	72760008
80	3"	88.9	3.2	51	72760009
100	4"	114.3	3.6	64	72760012
125	5"	139.7	4.0	76	72760014
150	6"	168.3	4.5	89	72760016

**REDUCȚIE CONCENTRICĂ SUDABILĂ - DIN 2605-1**

ПЕРЕХОДНИК КОНЦЕНТРИЧЕСКИЙ - DIN 2605-1

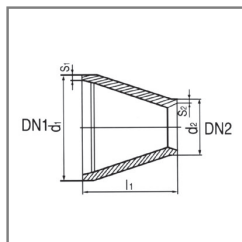

Ø (toli) (дюйм)	DIAM. d1 Ø d1	DIAM. d2 Ø d2	COD ROMSTAL КОД ROMSTAL
1 1/4 x 1"	42	33	45999013
1 1/4 x 3/4"	42	27	45999012
1 1/2 x 1 1/4"	48	42	45999017
1 1/2 x 1"	48	33	45999016
1 1/2 x 3/4"	48	27	45999015
1 1/2 x 1/2"	48	21	45999014
2 x 1/2"	60	21	45999018
2 x 1 1/4"	60	42	45999021
2 x 1 1/2"	60	48	45999022
2 x 1"	60	33	45999020
2 x 3/4"	60	27	45999019
2 1/2 x 2"	73	60	45999026
2 1/2 x 1 1/2"	73	48	45999025
2 1/2 x 1 1/4"	73	42	45999024
2 1/2 x 1"	73	33	45999023
3 x 1"	89	33	45999027
3 x 2 1/2"	89	73	45999031
3 x 2"	89	60	45999030
3 x 1 1/4"	89	48	45999028
3 x 1 1/2"	89	42	45999029
4 x 1 1/4"	114	48	45999032
4 x 3"	114	89	45999036
4 x 2 1/2"	114	73	45999035
4 x 2"	114	60	45999034
4 x 1 1/2"	114	48	45999033
5 x 4"	141	114	45999038
5 x 3"	141	89	45999037
6 x 3"	168	89	45999039
6 x 5"	168	141	45999041
6 x 4"	168	114	45999040

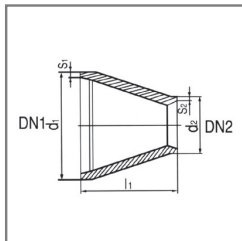
**REDUCȚIE CONCENTRICĂ SUDABILĂ - DIN 2605-1**  
**ПЕРЕХОДНИК КОНЦЕНТРИЧЕСКИЙ - DIN 2605-1**

Ø (toli) (дюйм)	DIAM. d1 Ø d1	DIAM. d2 Ø d2	COD ROMSTAL КОД ROMSTAL
6 x 3"	168	89	45999039
8 x 6"	219	168	45999070
8 x 5"	219	141	45999071
10 x 8"	273	219	45999068
10 x 6"	273	168	45999069

**RACORD SUDABIL DE BRANȘARE**  
**СЕДЛОВОЙ ОТВОД ПОД СВАРКУ**

DN (mm) (мм)	Ø (toli) (дюйм)	GROSIME PERETE толщ. стенки	COD ROMSTAL КОД ROMSTAL
20	3/4"	2.0	72720001
25	1"	2.3	72720002
32	1 1/4"	2.6	72720003
40	1 1/2"	2.6	72720004
50	2"	2.9	72720005
65	2 1/2"	2.9	72720007
80	3"	3.2	72720008
100	4"	3.6	72720011
125	5"	4.0	72720013
150	6"	4.5	72720015

**COT SUDABIL DE BRANȘARE LA 90°**  
**СЕДЛОВОЙ ОТВОД ПОД 90°, СВАРНОЙ**

DN (mm) (мм)	Ø (toli) (дюйм)	GROSIME PERETE толщ. стенки	COD ROMSTAL КОД ROMSTAL
32	1 1/4"	2.6	72730001
40	1 1/2"	2.6	72730002
50	2"	2.9	72730003
65	2 1/2"	2.9	72730005
80	3"	3.2	72730006
100	4"	3.6	72730009
125	5"	4.0	72730011
150	6"	4.5	72730013