

Destinatar

Firma
Referinta
Adresa
Phone
Fax
E-mail

Expeditor

Cod articol :

60150986

Articol:

EVOPLUS B 150/340.65 M

Date pompa

Presiune nominala: 16 bar
Temperatura min. fluid -10 °C
Temperatura max. fluid 110 °C
EEI : ≤ 0,20

Presiune minima la nivelul apei:

Temperatura : °C 90 100
Presiune minima la nivelul apei: m 20 25

Date de functionare cerute

Debit : 0,00 m³/h
Înălțime de pompare : 0,00 m
Fluid pompat (%) : Ap
Temperatura fluid: 20 °C
Densitate 0,99819 kg/dm³
Vascozitate cinematica: 1,0004 mm²/s
Presiune de vapori: 2,20 kPa

Date disponibile:

Debit :
Înălțime de pompare :

Materiale

Corp pompa Cast iron 250 UNI ISO 185 - CTF
Rotor Tecnopolimer
Arbore motor Otel inox
Inel de etansare EPDM
Carcasa motorului Aluminu turnat la cald
Flansa de inchidere Otel inox
Suport inel de echilibrare Otel inox

Date motor

Marca : DAB
Putere absorbita P1 1,21 kW
Tensiune nominala : 1~ 220-240 V 50 Hz
Curent nominal : 5,5 A
Grad de protec ie: IP 44

Curve tolerance according to ISO 9906

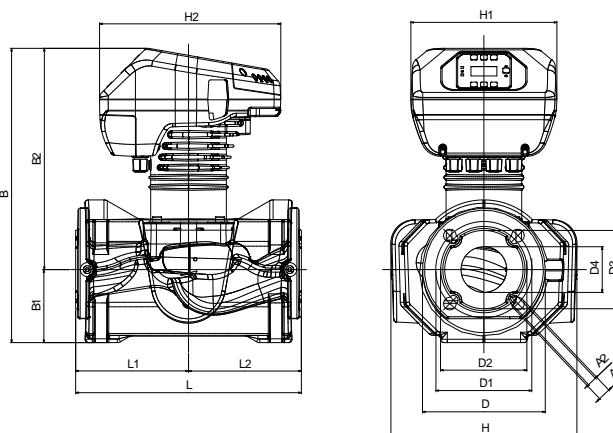
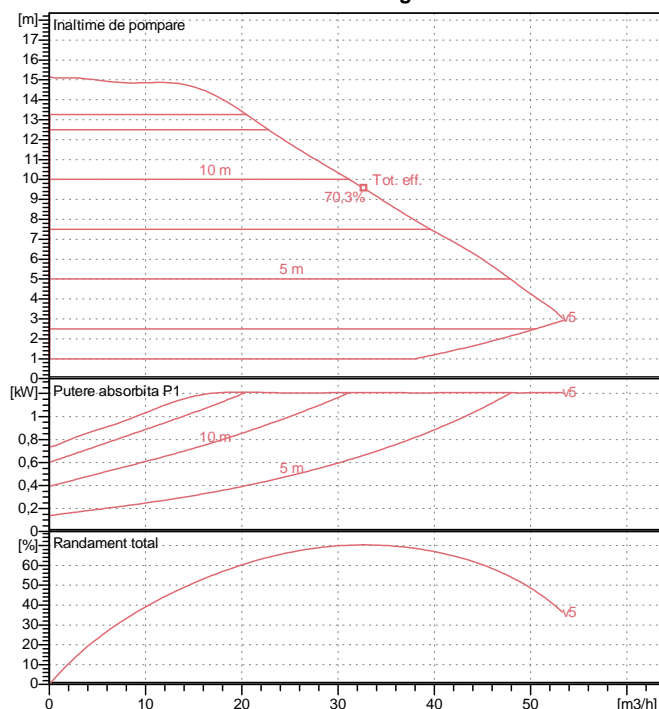

Dimensiuni de gabaritmm

A1	19	D	185	H	280	L2	170
A2	14	D1	145	H1	220		
B	443	D2	130	H2	273		
B1	110	D3	118	L	340		
B2	333	D4	69	L1	170		

Masa 27 kg

Racorduri pompa:

Partea cu aspiratia: DN 65 / PN6, PN10, PN16 (4 slotted holes)
Partea cu ref ularea: DN 65 / PN6, PN10, PN16 (4 slotted holes)

Destinatar	Expeditor
Firma Referinta Adresa Phone Fax E-mail	

EVOPLUS B 150/340.65 M

Curve tolerance according to ISO 9906

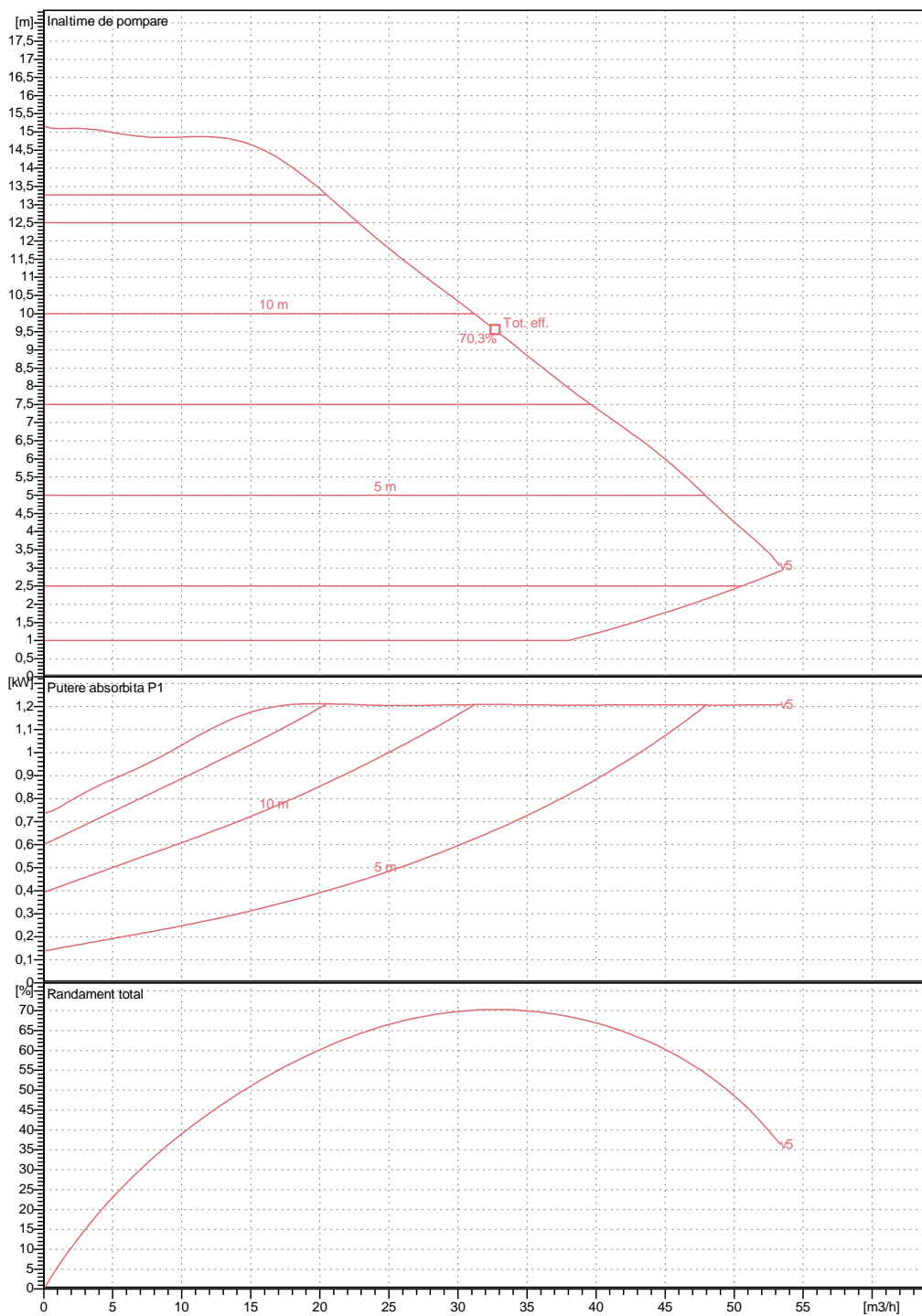

Date disponibile:

Partea cu aspiratia: DN 65 PN6, PN10, PN16 (4 slotted holes)	Partea cu refularea: DN 65 PN6, PN10, PN16 (4 slotted holes)	Debit : 0 m³/h	Inaltime de pompare : 0 m	Viteza nominala: 2900 1/min
Oferta	ID oferta	Creat de	Creat	08/19/2020

Destinatar

Expeditor

Firma
Referinta
Adresa
Phone
Fax
E-mail

EVOPLUS B 150/340.65 M

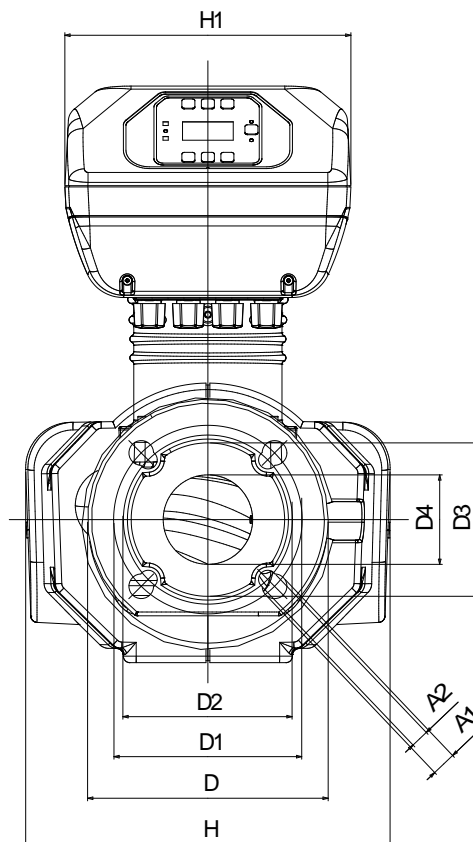
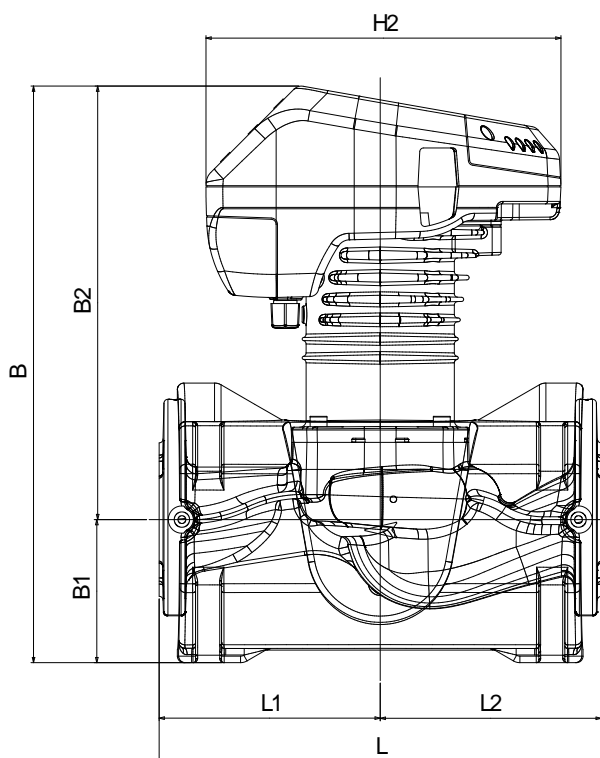

Dimensiuni in mm

1	A1	19	H	280
2	A2	14	H1	220
3	B	443	H2	273
4	B1	110	L	340
5	B2	333	L1	170
6	D	185	L2	170
7	D1	145		
8	D2	130		
9	D3	118		
10	D4	69		

Racorduri pompa:

Aspiratie
DN 65
PN6, PN10, PN16 (4 slotted holes)

Refulare
DN 65
PN6, PN10, PN16 (4 slotted holes)

Oferta

ID oferta

Creat de

Creat

08/19/2020